



Hardware Installation Manual

Standard Mount

1. Components



Mount



Hardware Set

2. Assembling EyeRIS & USB cable on standard mount

Step 1 - Use Allen key provided in hardware set to unscrew only one screw as shown below & remove the L-plate.



Step 2 - Unscrew both M3 screw using PH 0 screwdriver & remove the plate as shown below:

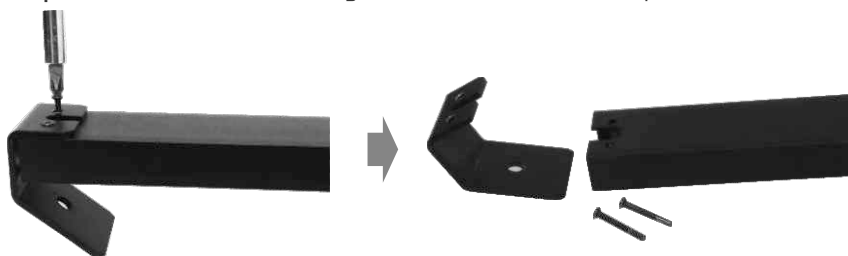

Step 3 - Take USB cable provided in the box and insert "Type-A" connector end of the USB cable through mount as shown below:

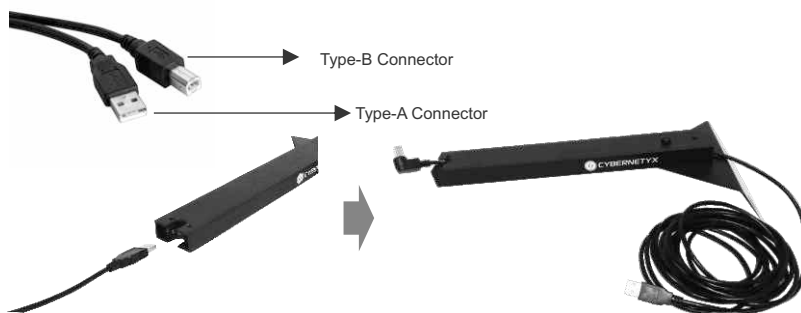

Step 4 - Fix EyeRIS on plate using M6 screw provided in the hardware set.
Use PH 2 screw driver



Step 5 - Use M3 screw and PH 0 screw driver to secure the plate on the mounting rod as shown below:

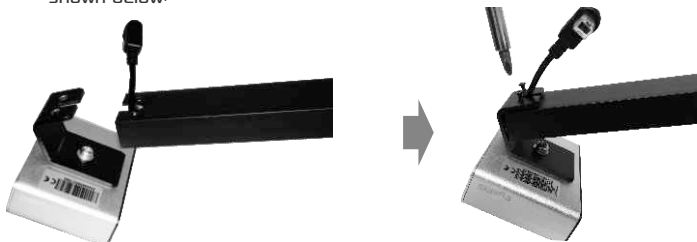

Step 6 - Use Allen key to secure the L-plate and the USB cable in mounting rod.



Step 7 - Connect USB cable "Type B" connector to the EyeRIS and it is ready to be installed on the wall

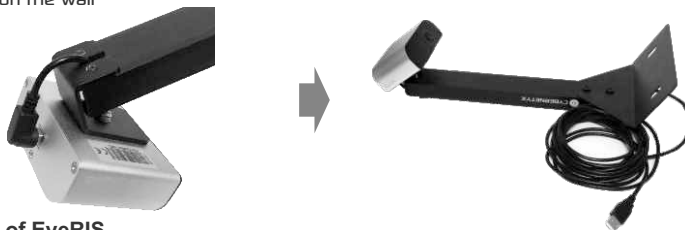

3. Installation of EyeRIS

Step 1 - Measure 33" from the floor & fix the whiteboard on the wall at the desired location.

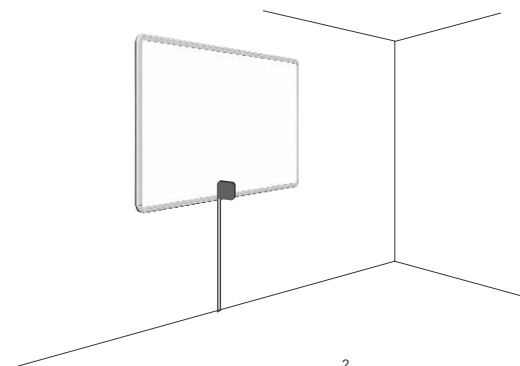

Step 2 - Mark the centre of the whiteboard as shown in the diagram below:

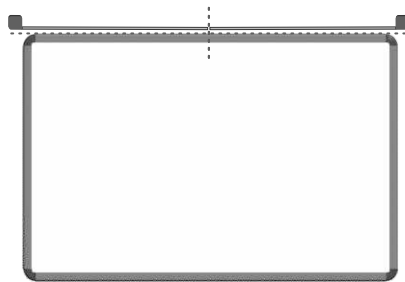

Step 3 - Place the EyeRIS mount on the wall & mark the holes as shown:

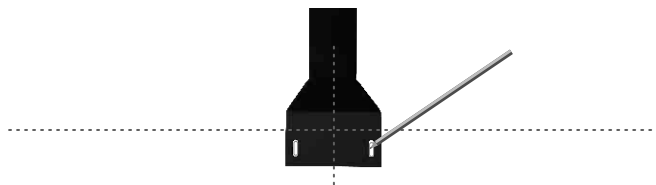

Step 4 - Use a drill machine to drill holes on the wall at the marked location.

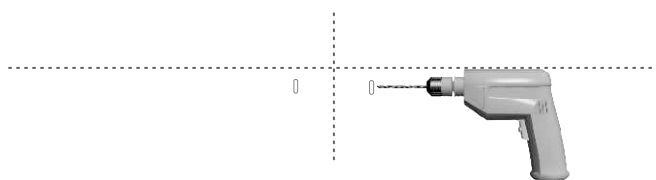

Step 5 - Fix the EyeRIS mount on the wall using plastic sleeve anchors & screws provided in the hardware set.

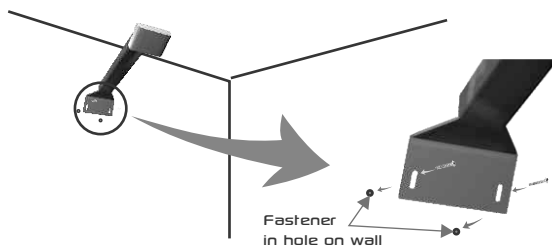

Step 6 - Place the whiteboard on the wall.

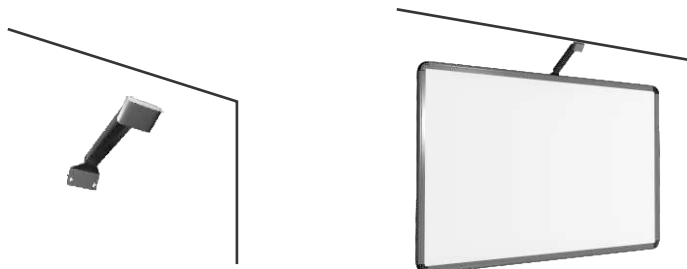

Step 7 - Stick OPTIBAR strips on whiteboard as shown below (Optional) & proceed for calibration.

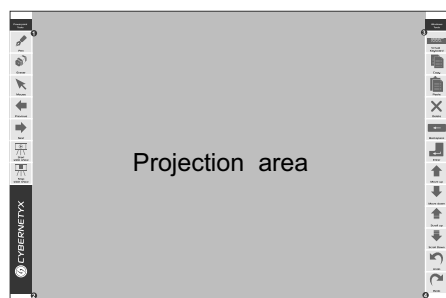

4. Finished setup

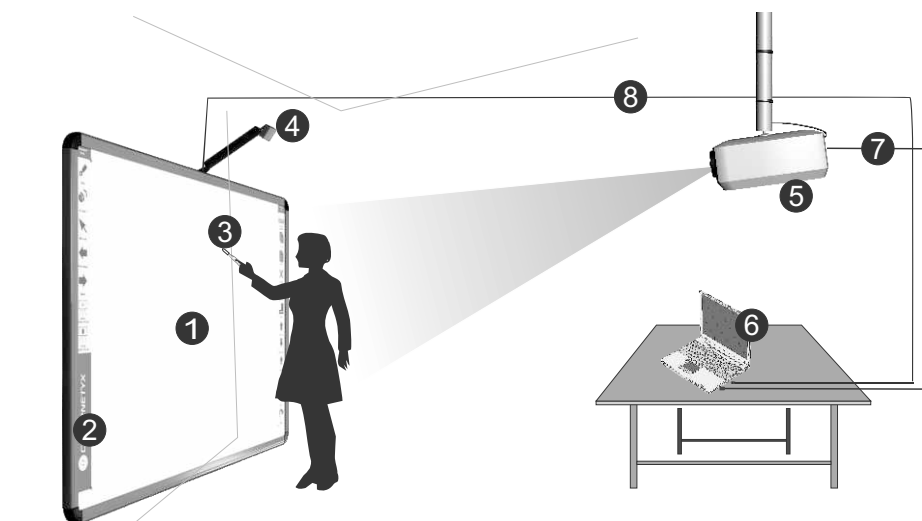

1. Projection Area
2. Optibar
3. Stylus
4. EyeRIS 8090UST
5. Projector
6. PC/Laptop
7. VGA or HDMI Cable
8. USB Cable