

Components for Standard Mount Setup

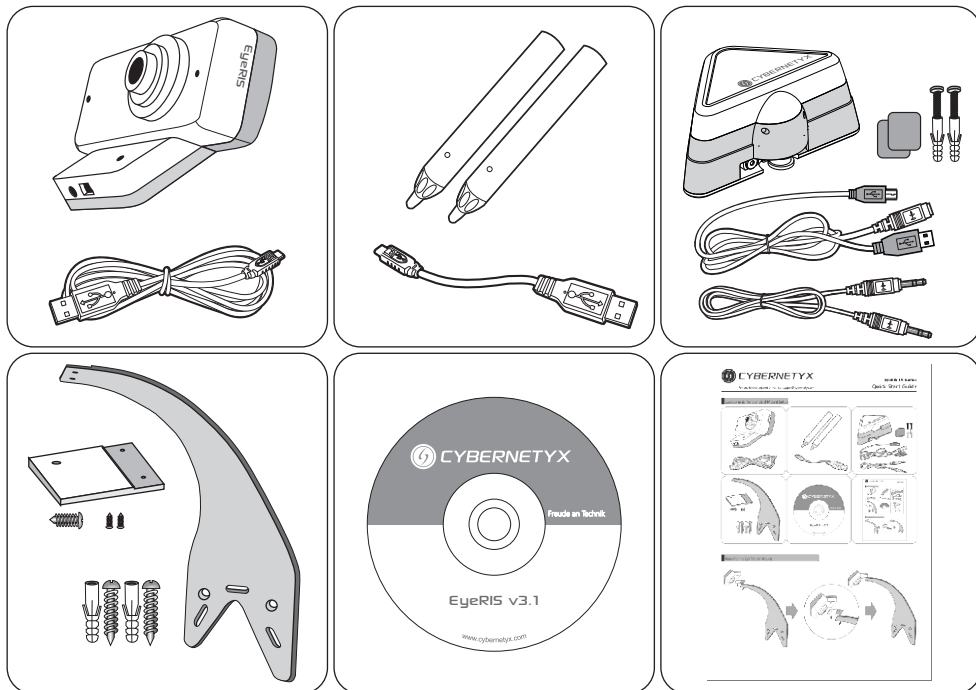

Assembling EyeRIS on Mount

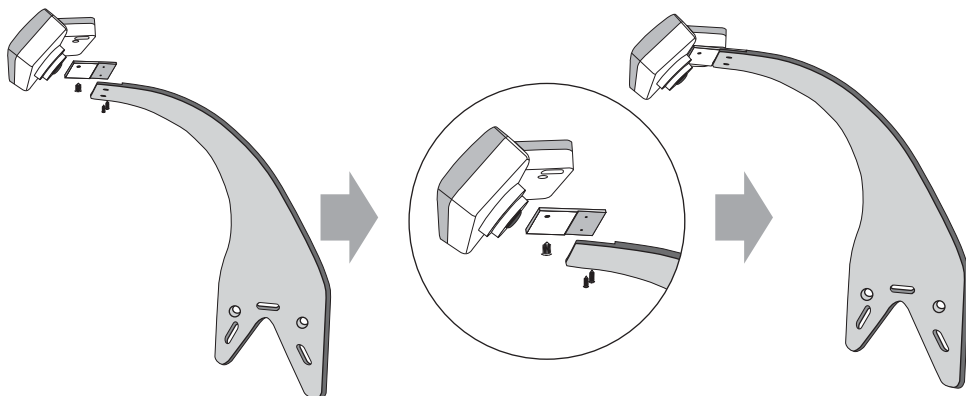

Installing EyeRIS Standard Mount on whiteboard

1. Measure and mark center & top point of whiteboard as shown below:

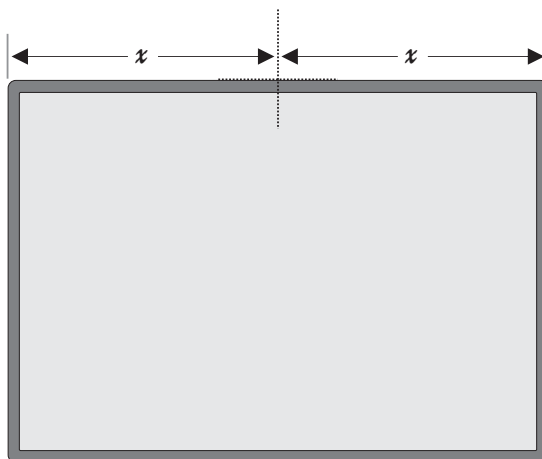

2. Place EyeRIS mount & mark the holes as shown below

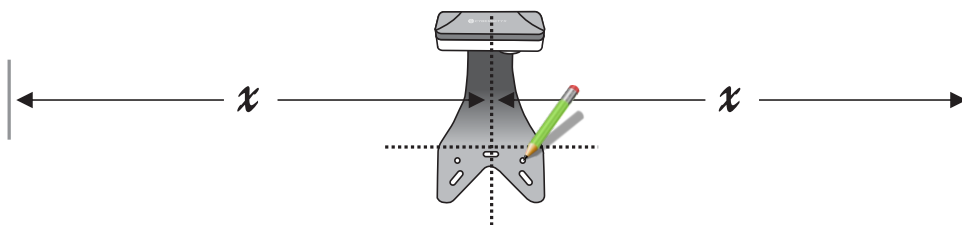

3. Drill holes on wall using a drill machine



4. Fix plastic wall fishers and screws provided in the h/w set to fix mount as shown below

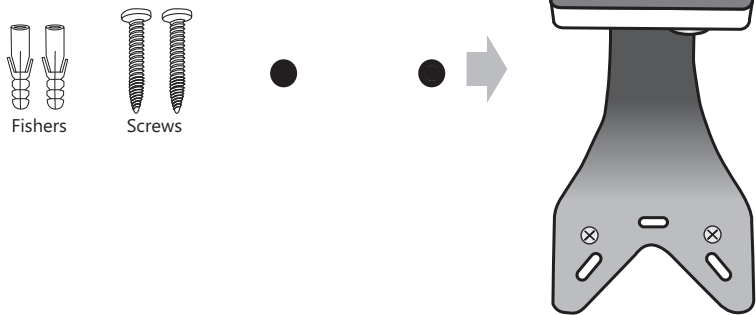

5. Place back the whiteboard on wall

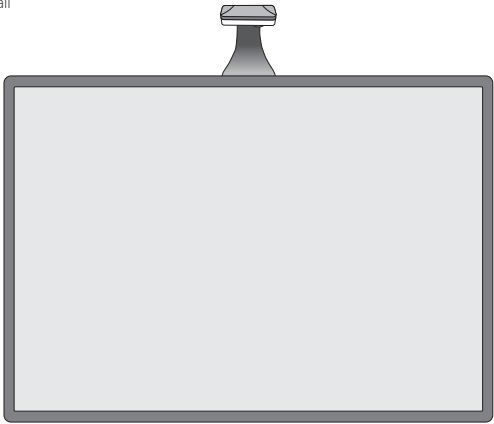

Installing TOUCH v2.0 on whiteboard

Fix TOUCH unit using double sided tape or magnets as shown below

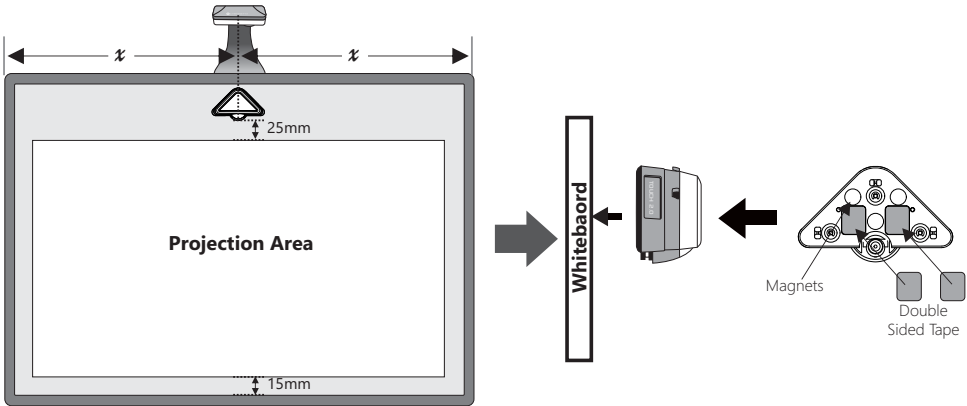

Installing TOUCH v2.0 on Wall

Fix TOUCH unit on the wall using plastic wall fisher and screws as shown below

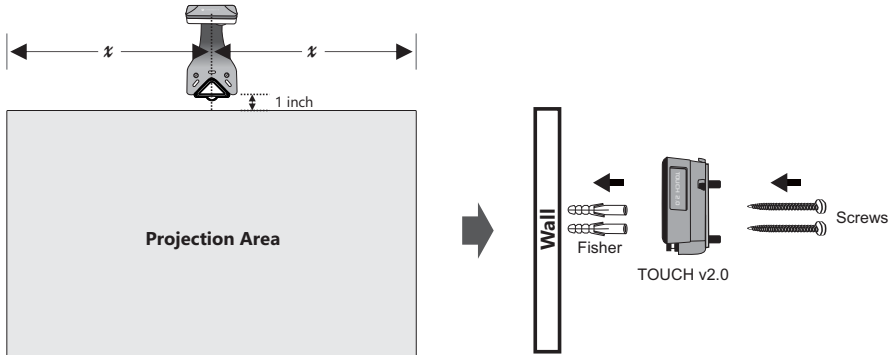

Fixing OPTIBAR

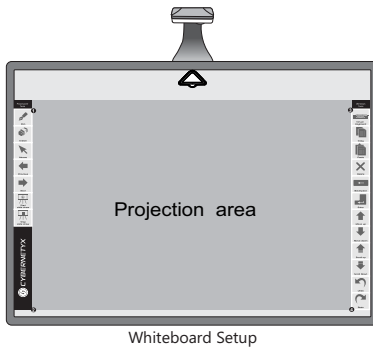

Whiteboard Setup

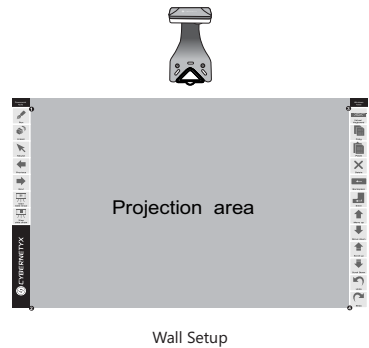

Wall Setup

Following points should be taken care while using OPTIBAR Setup:

- 1) OPTIBAR stickers to be used only in following projection setup.
 - a) When using 6'x4' Board and projection is 78 inch diagonal in 4:3 Aspect Ratio (making total diagonal size including OPTIBAR as 84 inch. As shown above.
 - b) When the projection is in 16:9 aspect ratio and vertical size of projection not exceeding 4 feet and total diagonal size of setup including OPTIBAR is not more than 90 inch.
- 2) In any case the width (vertical) of projection should not be more than the OPTIBAR size.
- 3) Projected surface should not overlap the OPTIBAR stickers.
- 4) The distance between the edge of Projection and OPTIBAR sticker should not be more than 10mm.

Connectivity

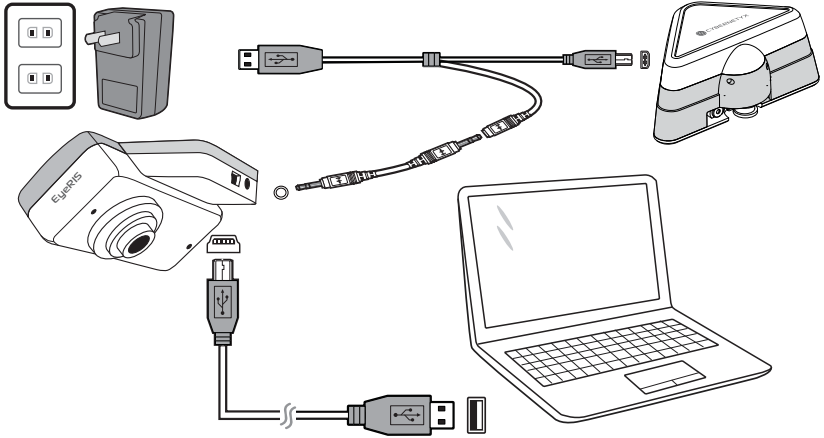

Align TOUCH

1. Press 'Align' button to turn ON the red line Laser

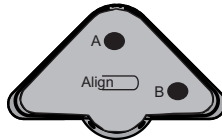

2. Rotate Gear 'A' counter clockwise so that red line laser is visible on the surface



3. Adjust Gear 'B' so that the red line laser becomes parallel to wall or board surface



4. Rotate Gear 'A' clock wise to bring red line laser as close to the board or wall surface as possible.



5. Make sure the red line laser is not incident on the wall or board surface.

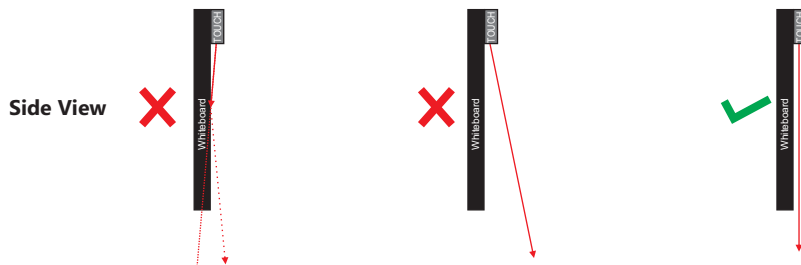

Calibrating of EyeRIS

